



CIDADE DE GOA HERITAGE  
GOA

A photograph of a resort building with a swimming pool. The building is multi-story and features a mix of warm colors: red, orange, and yellow. It has several balconies and windows with white frames. In the foreground, there is a swimming pool with blue water. The poolside is paved and has several lounge chairs with yellow cushions and white umbrellas. Palm trees are visible on the left side of the building. The sky is a clear, bright blue with a few wispy clouds.

EVENTS AND OCCASIONS



*N*estled along the shores of Vainguinim Beach, Taj Cidade de Goa Heritage is a charming Portuguese hamlet with a Mediterranean flair. Historic murals, intimate alcoves, winding passageways, and timeless *balcões* echo the *susegad* spirit.

Offering 201 rooms, including 15 suites, some overlooking the sea, the resort has exceptional venues for corporate events, making every gathering truly impactful.





## MANDOVI & ZUARI LAWNS



*S*prawling lawns overlooking the Arabian Sea, offering an enchanting open-air setting for gala dinners, celebrations, and corporate gatherings.



# MANDOVI & ZUARI LAWNS FLOOR PLAN & DIMENSIONS

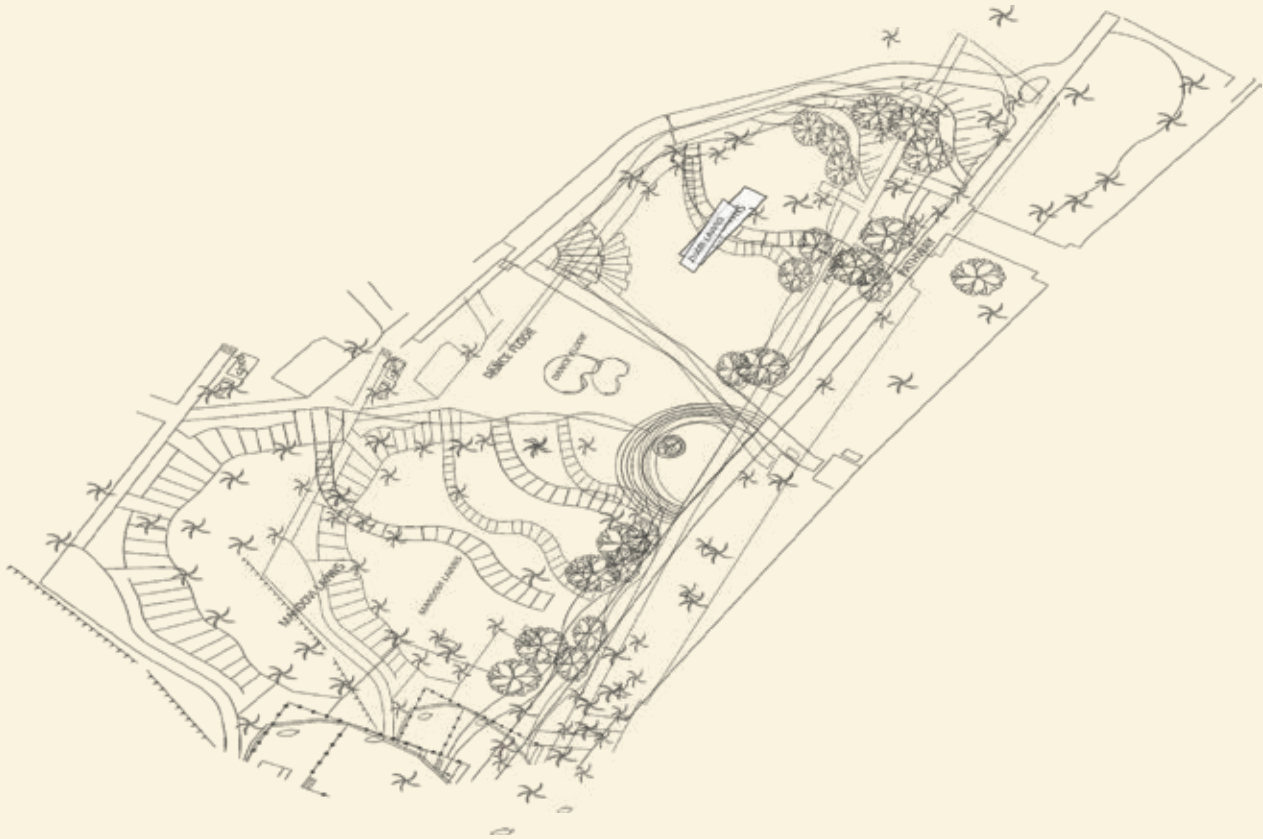

## DIMENSIONS & SEATING CAPACITIES



Area (sq. m.)	Dimensions (ft.)	Height (ft.)	Theatre	Cluster	Floating
2800	-	-	1000 pax	550 pax	1200 pax



## SUNSET LAWNS



*S*urrounded by lush greenery and reached via an elegant arched wooden bridge, this secluded enclave reveals breathtaking sea views. It's the perfect setting for intimate ceremonies, team retreats or creating lasting memories.



# SUNSET LAWNS FLOOR PLAN & DIMENSIONS



## DIMENSIONS & SEATING CAPACITIES



Area (sq. m.)	Dimensions (ft.)	Height (ft.)	Theatre	Cluster	Floating
1000	-	-	300 pax	150 pax	350 pax





## POOLSIDE LAWNS



*S*et beside the pool, and framed by the Arabian Sea and verdant trees, this venue is perfect for small, unforgettable gatherings.



# POOLSIDE LAWNS FLOOR PLAN & DIMENSIONS

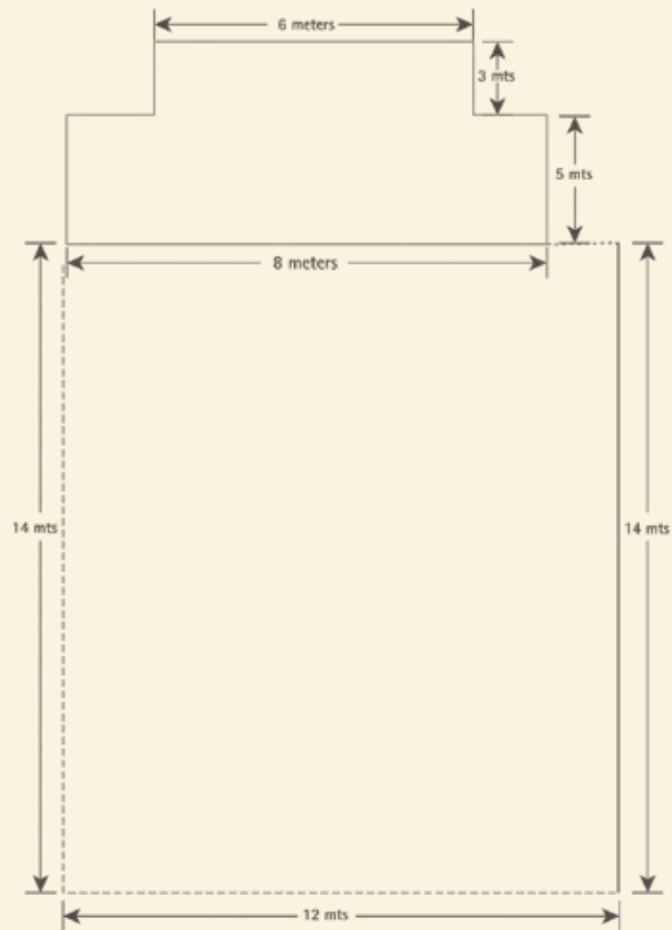

## DIMENSIONS & SEATING CAPACITIES



Area (sq. m.)	Dimensions (ft.)	Height (ft.)	Theatre	Cluster	Floating
500	-	-	90 pax	40 pax	100 pax





## GRANDE SALA



*A* distinctively designed, expansive ballroom with chic interiors and chequered floors, ideal for conferences or grand events.



# GRANDE SALA FLOOR PLAN & DIMENSIONS

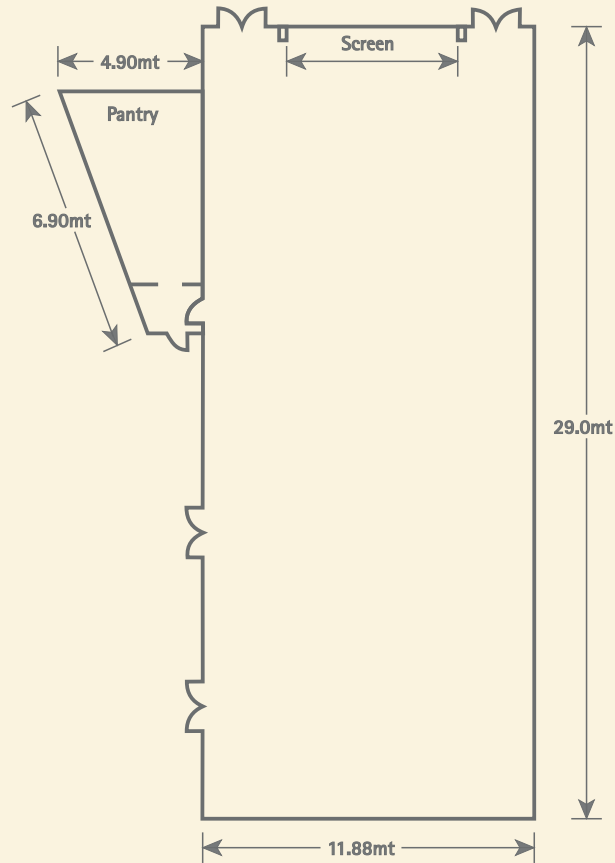

## DIMENSIONS & SEATING CAPACITIES



Area (sq. m.)	Dimensions (ft.)	Height (ft.)	U-Shaped	Rectangle	Classroom	Theatre	Cluster	Floating
350	96.1 x 39	11.2	72 pax	65 pax	120 pax	400 pax	140 pax	450 pax



## SALA DE BANQUETE



*E*legant and thoughtfully designed, this banquet hall sets the tone for productive discussions, and opens out to a rustic alfresco terrace.





# SALA DE BANQUETE FLOOR PLAN & DIMENSIONS

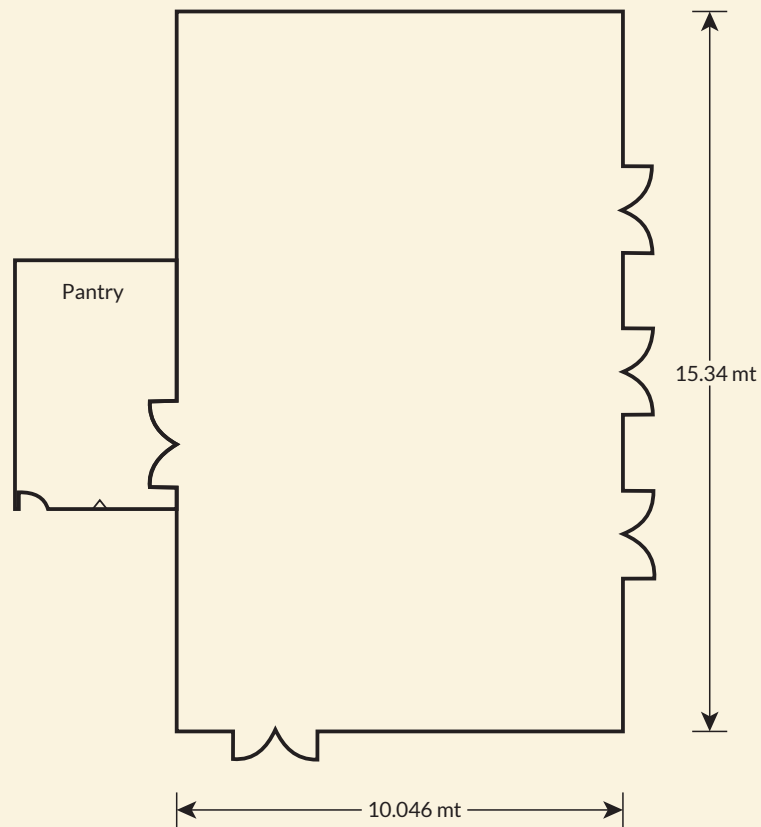

## DIMENSIONS & SEATING CAPACITIES



Area (sq. m.)	Dimensions (ft.)	Height (ft.)	U-Shaped	Rectangle	Classroom	Theatre	Cluster	Floating
160	50.5 x 33.3	11.2	42 pax	35 pax	48 pax	110 pax	55 pax	150 pax



# ULTRAMAR 1



*A* well-appointed boardroom equipped with state-of-the-art facilities, designed for successful corporate meetings.



# ULTRAMAR 1 FLOOR PLAN & DIMENSIONS

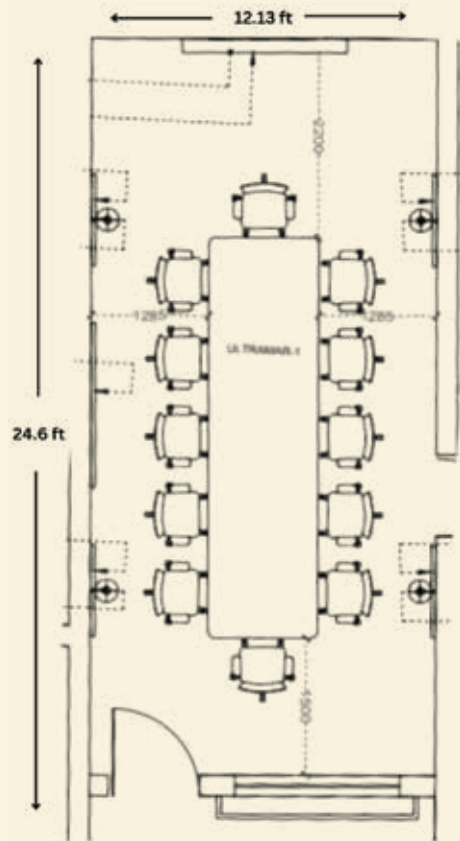

## DIMENSIONS & SEATING CAPACITIES



Area (sq. m.)	Dimensions (ft.)	Height (ft.)	U-Shaped
29.17	25.9 x 12.1	9.2	15 pax





## ULTRAMAR 2



*A*n intimate boardroom with a sleek table and ergonomic seating, creating the ideal setting for exclusive business events.



# ULTRAMAR 2 FLOOR PLAN & DIMENSIONS

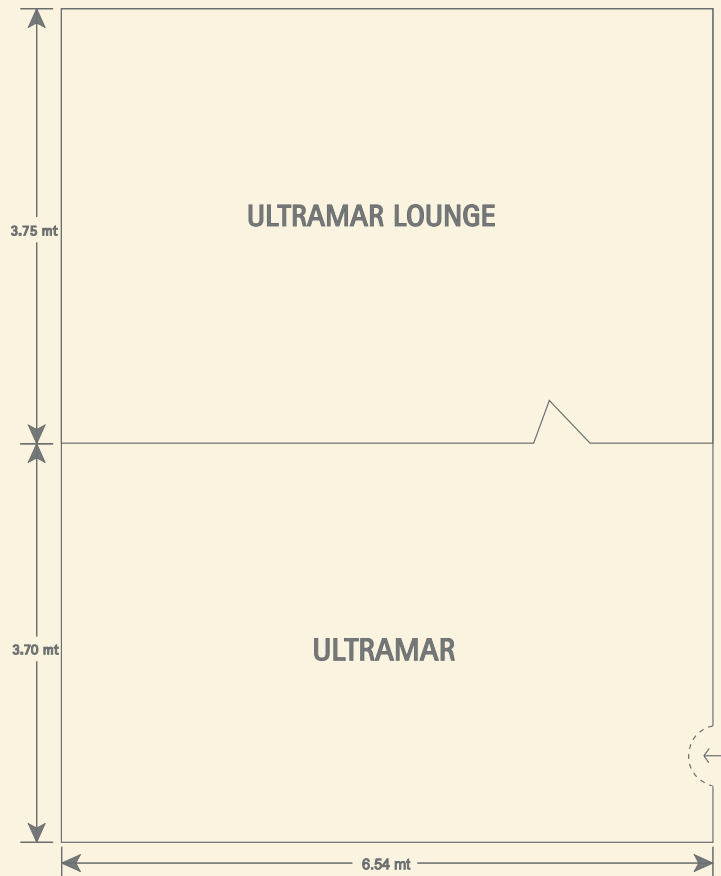

## DIMENSIONS & SEATING CAPACITIES



Area (sq. m.)	Dimensions (ft.)	Height (ft.)	U-Shaped
24.8	22 x 12.1	8.2	6 pax



  
TAJ  
CIDADE DE GOA HERITAGE  
GOA