



# TAJ LAKE PALACE UDAIPUR



## EVENTS AND OCCASIONS



*Taj Lake Palace, Udaipur, a masterpiece built in 1743 by Maharana Jagat Singh II, once the Mewar royals' summer retreat, now stands as a heritage haven. Overlooking Lake Pichola, it offers royal weddings, grand celebrations, elite meetings, and private gatherings. With venues like Jagmandir Island Palace, it blends timeless history, breathtaking views, and Taj's intuitive service culture.*



# JAGMANDIR ISLAND PALACE



*Jagmandir Island Palace, fondly known as Swarg ki Vatika, is an idyllic 17th-century masterpiece intricately woven into the regal legacy of Mewar. Set amidst the serene waters of Lake Pichola, this enchanting destination offers exquisite courts and gardens, perfect for hosting distinguished occasions. With heritage venues like Chaar Baagh, Kunwarpada Chowk, Spa Lawns, Courtyard Lawns, and an elegant Private Dining Room (8.2 mt. x 8.8 mt; 77 sq. mt.), every celebration is elevated with timeless grandeur and romance.*



## JAGMANDIR ISLAND PALACE - FLOOR PLAN



### DIMENSIONS & SEATING CAPACITIES



	Area (m <sup>2</sup> )	Dimensions (m.)	Ceiling Height (m.)	Theatre	Cluster	Informal
Jagmandir Island Palace	3456	96 x 36	-	-	-	-
Kunwarpada Chowk	969.6	48 x 20.2	-	200 pax	300 pax	500 pax
Chaar Bagh	1763	41 x 44	-	320 pax	200 pax	500 pax
Courtyard Lawns	463.7	26.2 x 17.7	-	120 pax	60 pax	150 pax
Spa Lawns	260	12.19 x 21.36	-	60 pax	40 pax	80 pax

## MEWAR MAHAL



*Overlooking the serene Jhankar Courtyard, the elegantly designed Mewar Mahal is an ideal venue for high-level meetings and exclusive functions. Accommodating up to 75 guests in a theatre-style set-up, it is equipped with state-of-the-art audio-visual facilities and supported by seamless secretarial services, ensuring every event is executed with sophistication and precision.*



## MEWAR MAHAL - FLOOR PLAN

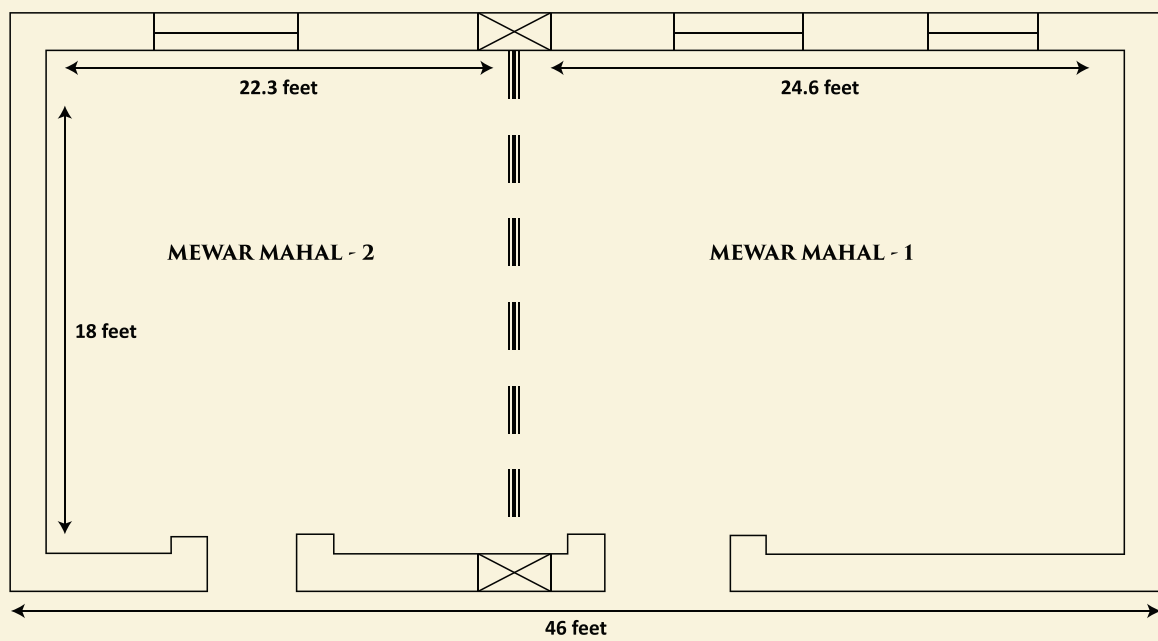

### DIMENSIONS & SEATING CAPACITIES



Area (m <sup>2</sup> )	Dimensions (m.)	Ceiling Height (m.)	Cluster	Classroom	Theatre
77	14 x 5	2.43	35 pax	35 pax	70 pax

## MEWAR TERRACE



*Spanning 487 sq. m with high ceilings, the Grand Ball Room accommodates up to 450 guests. Ideal for conferences, product launches, or corporate galas, it is one of Agra's premier 5-star venues, equipped with modern technology and supported by expert event planning services. A spacious pre-function area adds to the grandeur, providing the perfect setting for registrations, networking, or cocktail gatherings before the main event.*



## MEWAR TERRACE - FLOOR PLAN

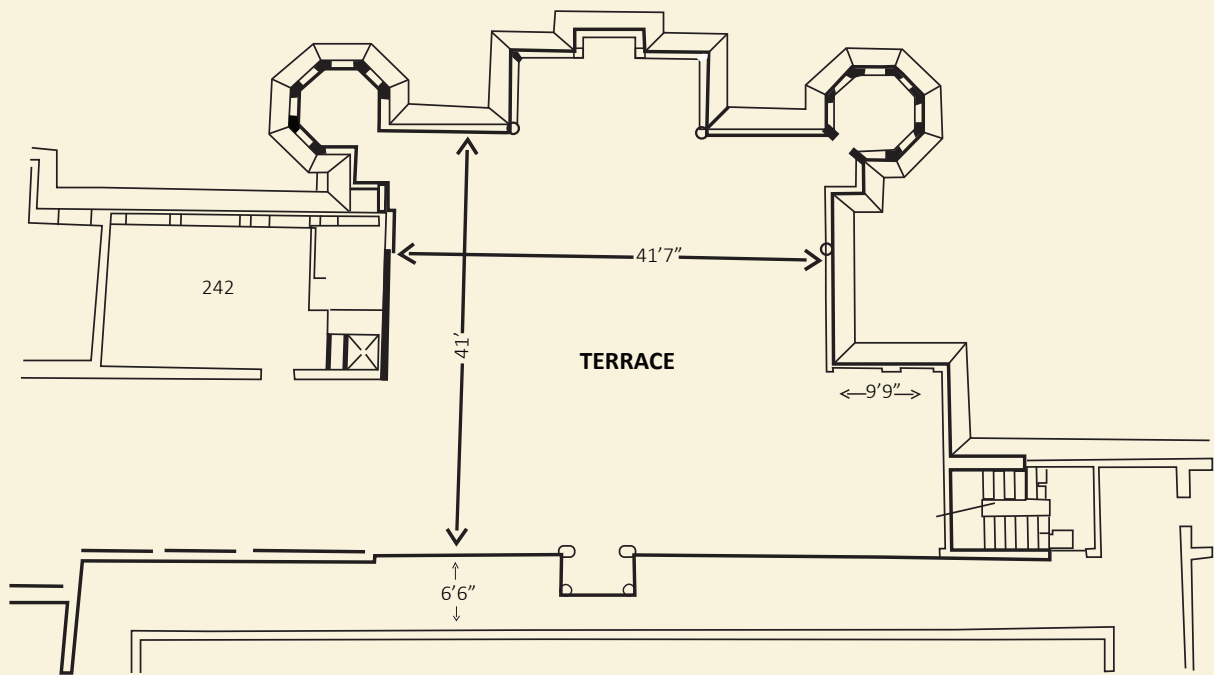

### DIMENSIONS & SEATING CAPACITIES



Area (m <sup>2</sup> )	Dimensions (m.)	Ceiling Height (m.)	Cluster	Classroom	Theatre
157	12.4 X 12.7	-	60 pax	70 pax	80 pax

## LILY POND



*The Lily Pond presents a refined outdoor setting, perfect for networking evenings, leadership cocktails, or post-conference receptions. Surrounded by landscaped gardens and a tranquil fountain, this elegant venue offers a refreshing ambience that inspires conversation, collaboration, and connection, making it an ideal choice for memorable corporate gatherings in Udaipur.*



## LILY POND - FLOOR PLAN

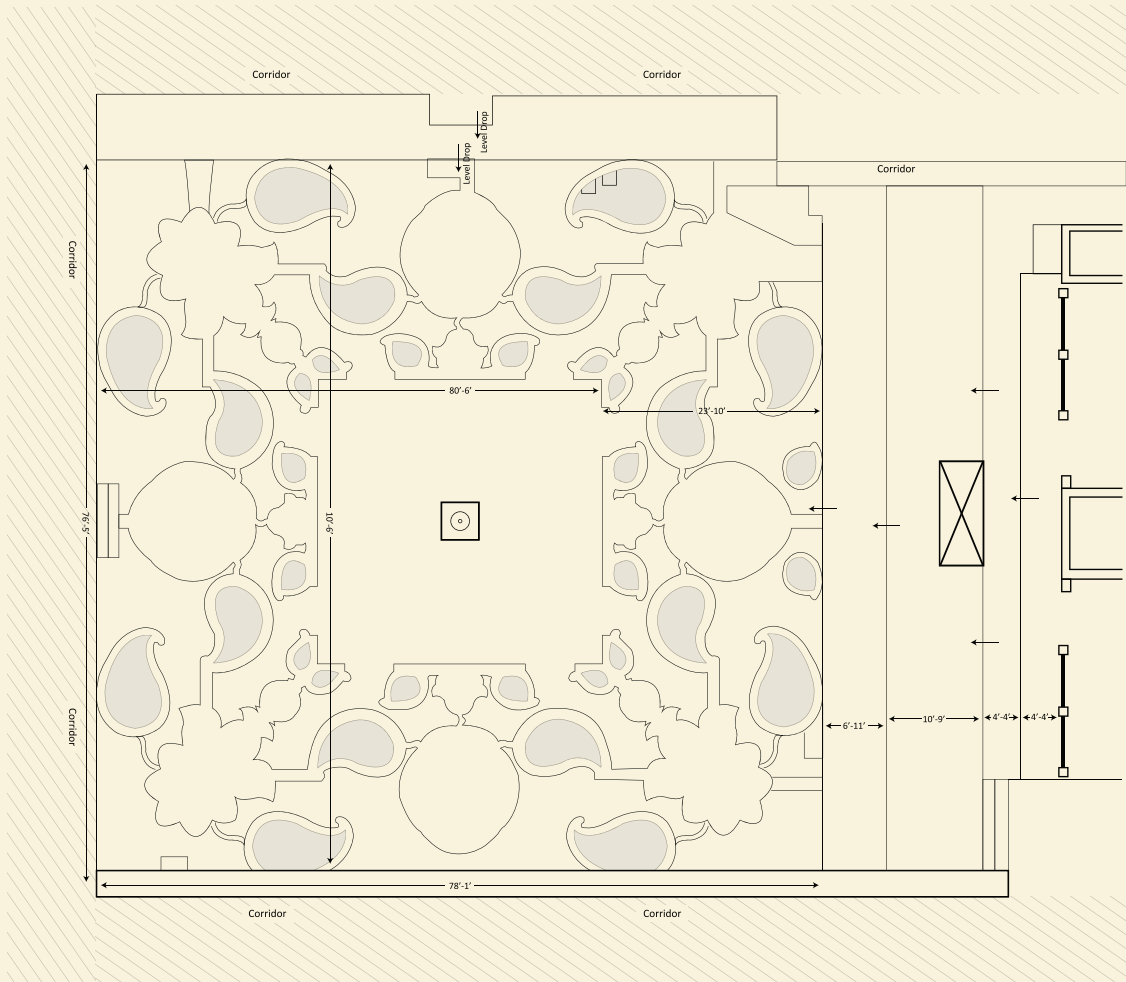

### DIMENSIONS & SEATING CAPACITIES



Area (m <sup>2</sup> )	Dimensions (m.)	Ceiling Height (m.)	Cluster	Classroom	Theatre
554.7	23.31 X 23.80	-	80 pax	-	150 (Informal) Pax



# TAJ LAKE PALACE UDAIPUR